





# SECHEVAL

Propriété de la Commune

PROPOSITION DE DIVISION

ECHELLE 1/500



-  Lot à bâtir
-  Branchement électrique (position à préciser)
-  Tracé de la conduite de gaz
-  Application cadastrale

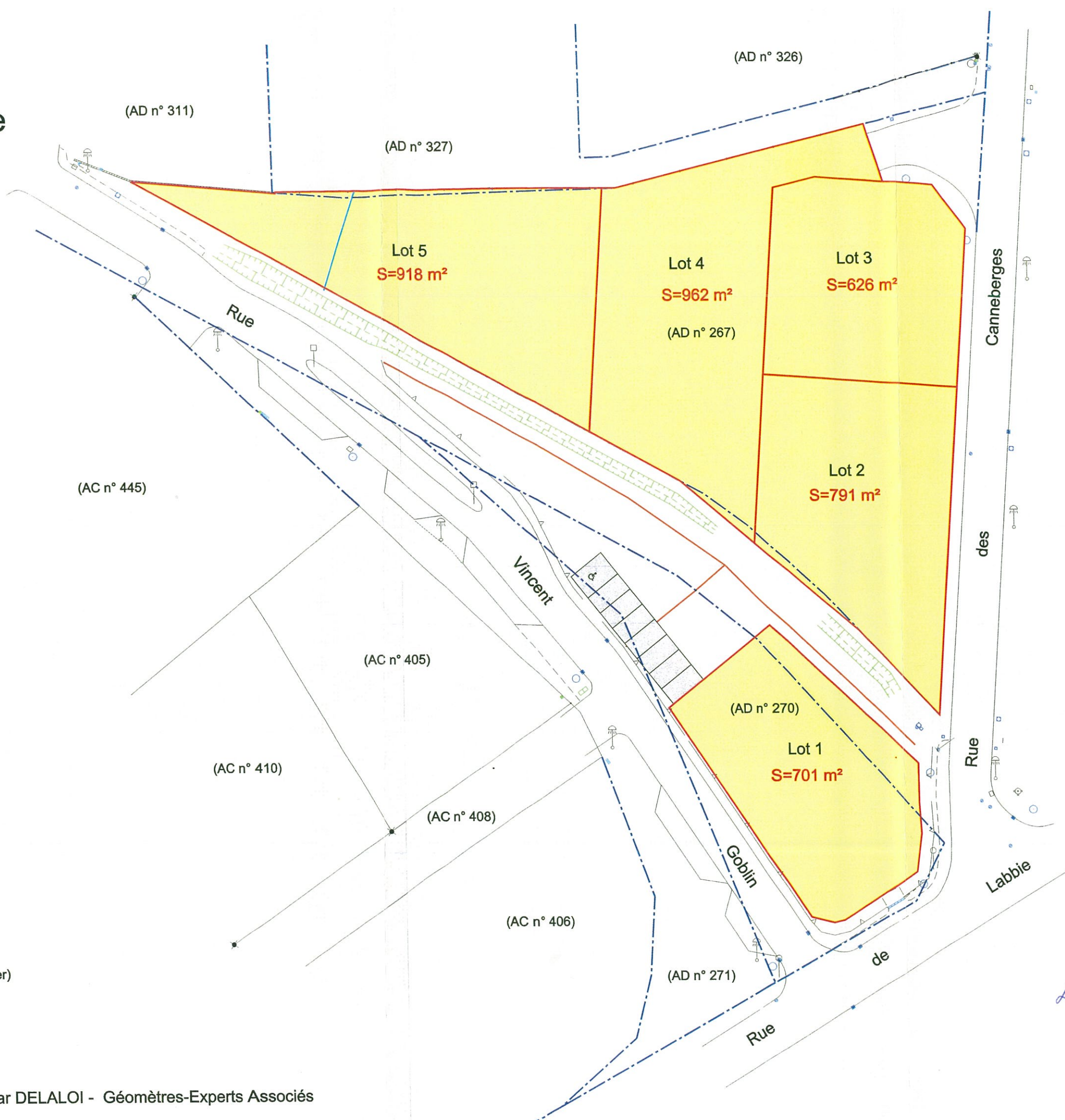

*Avis Favorable,*  
**SECHEVAL**  
- 9 JAN. 2016  
*Le Maire, P. ANBOT*

